

GENERAL FITTING GUIDE

BATH WASTE

1. Identify all components are present prior to installation.
2. Ensure you have all the relevant tools prior to installation.
3. Make sure all surface areas are clear from dirt or grit to ensure clean seals are achieved.
4. Take care to assemble all washers and components in the correct sequence.
5. Carefully assemble the new fitting onto the bath. DO NOT over-tighten as this may cause damage to the fitting and / or the bath.
6. Check all connections to ensure there are no leaks.
7. Check the assembled fit of the product to the bath to ensure there is no water ingress that may cause water damage after installation.

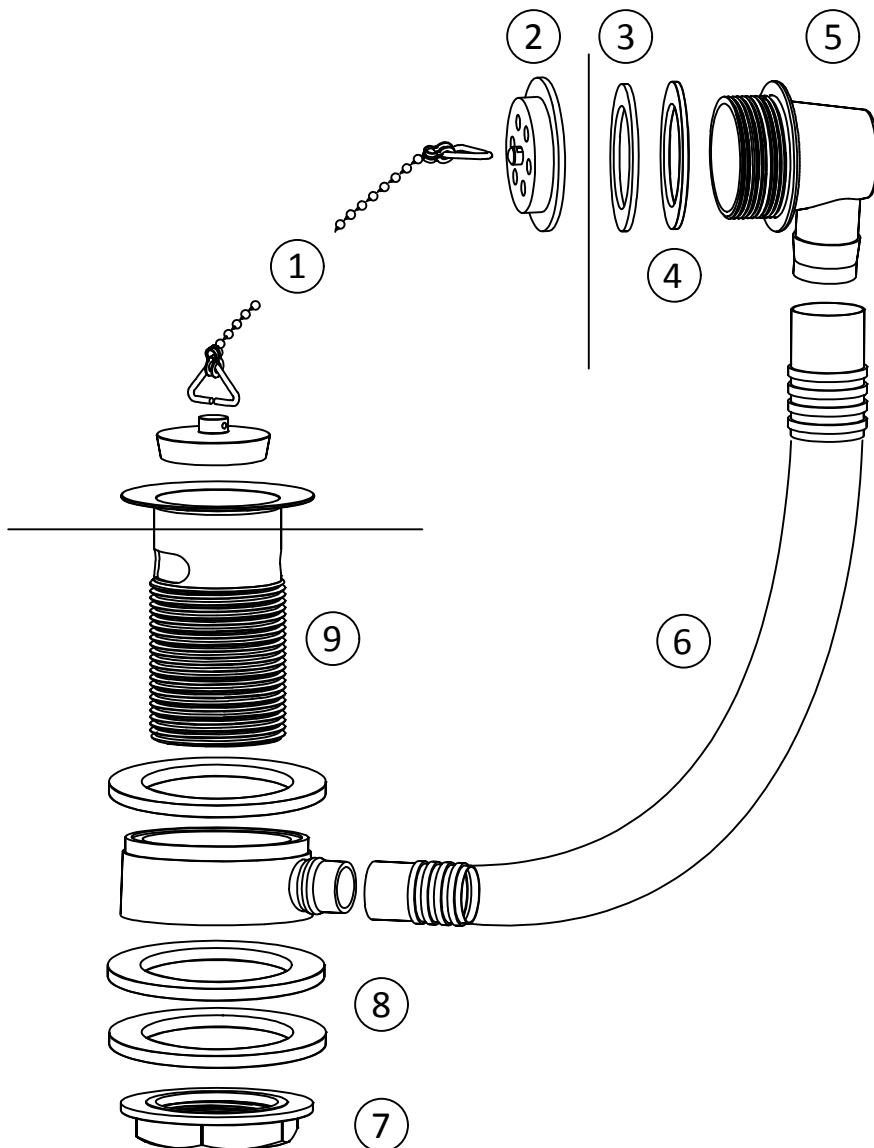

COMPONENTS

1. PLUG & CHAIN ASSEMBLY
2. OVERFLOW FACE
3. FLEXIBLE WASHER
4. RUBBER WASHER
5. OVERFLOW ELBOW
6. FLEXIBLE PIPE
7. FIXING NUT
8. RUBBER WASHERS
9. WASTE BODY